

NOTE — All drawings remain the property of Heronceau Properties Ltd. Only dimensioned measurements should be taken from the drawings, all measurements to be verified on site.

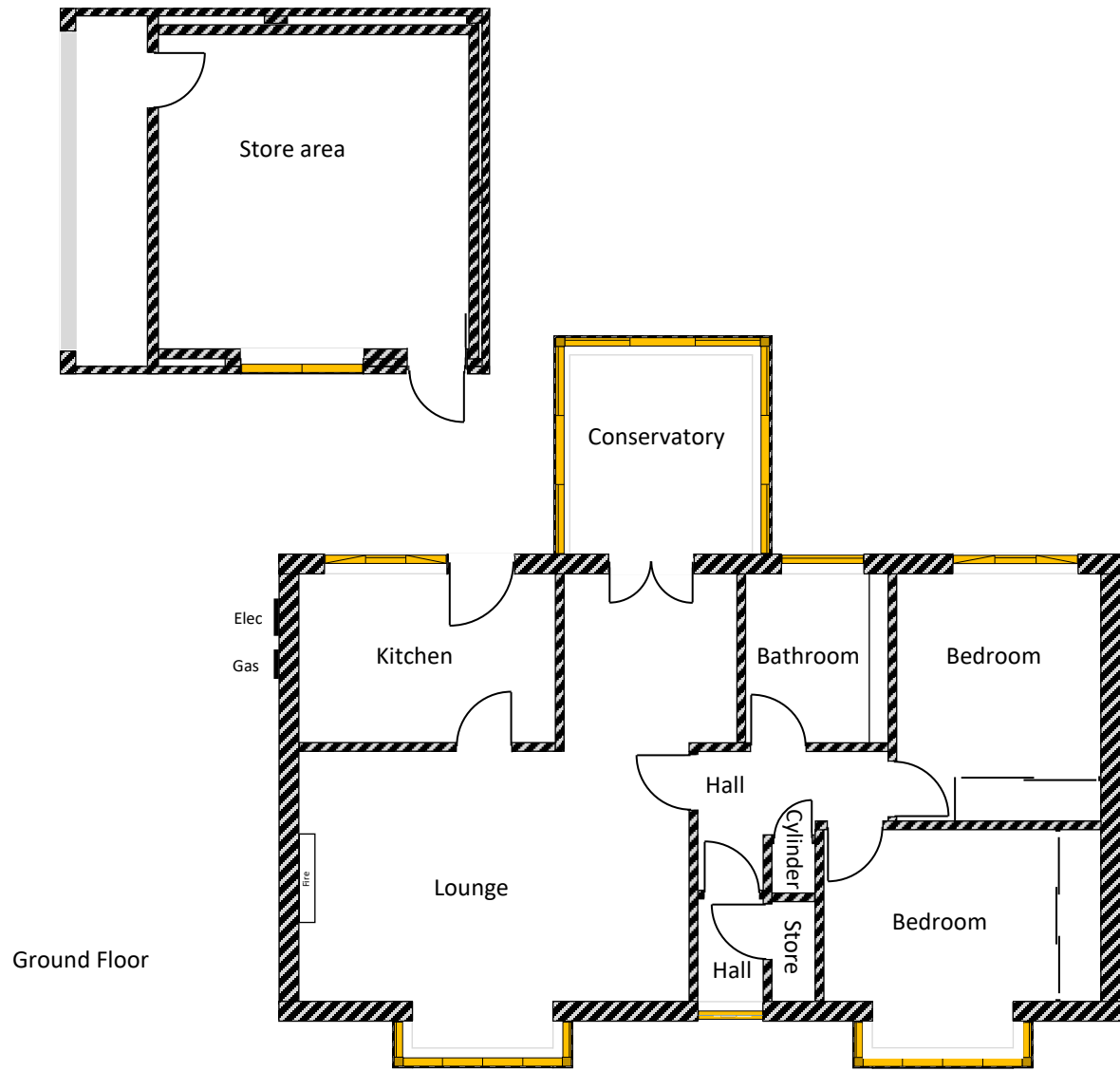

Ground Floor

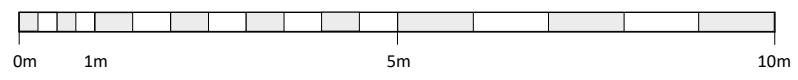

2 Earlswood Road,
Birches Head, ST1 6UF
DWG — 0106-02.01.00
Existing Ground Floor Plan
Scale 1:100 — A4